



**10A Darcy Place, Ashted, KT21 1SN**  
**£1,800 Per month**

 2  1  1  C

## AVAILABLE NOW

A first floor maisonette offering flexible accommodation with a good size garden including a well proportioned outbuilding, ideal for a home office, gym or games room.

Nestled in the corner of a quiet cul de sac in sought after Ashted, the layout includes two good size bedrooms, a generous reception room, a fitted kitchen and family bathroom with natural light. There is also access to a good size loft space and externally there is a brick built utility room. The cul de sac also has the benefit of residents parking.

Darcy Place is brilliantly located, close to many of the well regarded local schools and is within comfortable reach of the mainline station and the village shops.





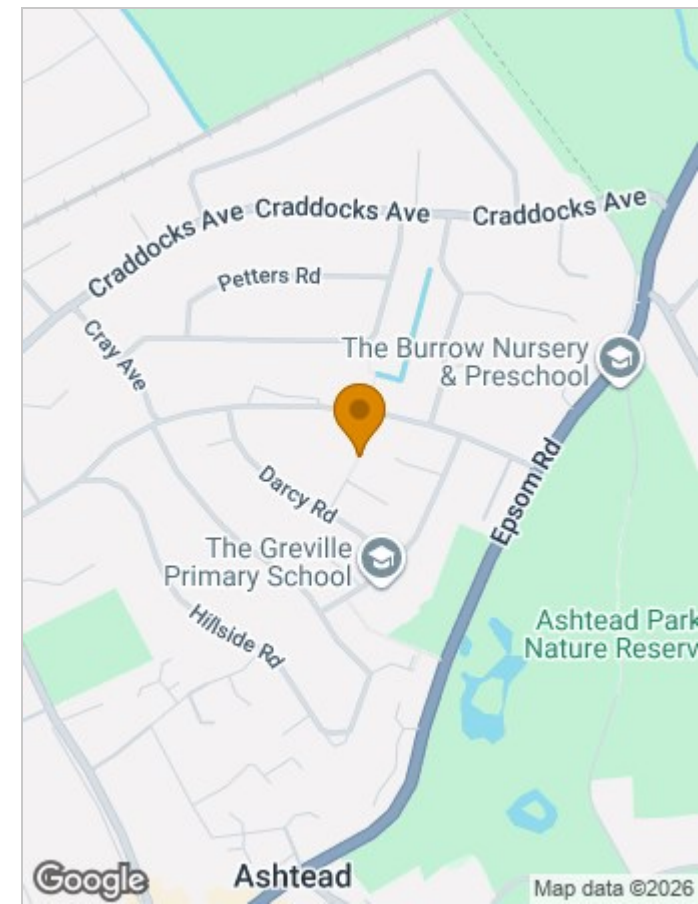
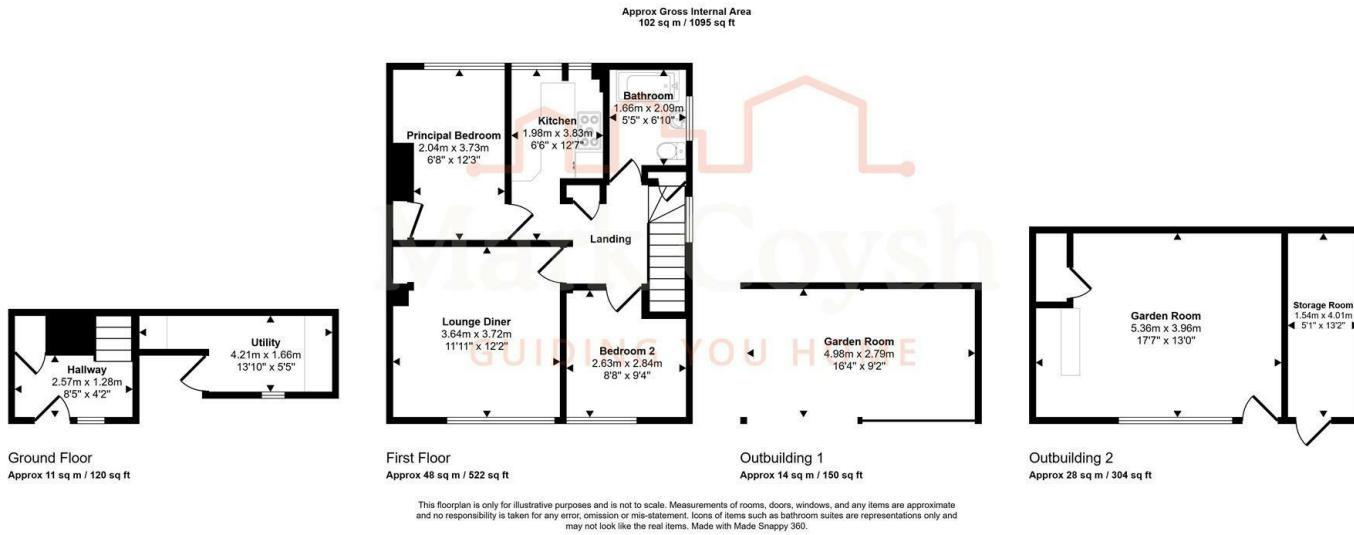

## Viewing

Please contact our Mark Coysh Office on 01372 303703 if you wish to arrange a viewing appointment for this property or require further information.

These particulars, whilst believed to be accurate are set out as a general outline only for guidance and do not constitute any part of an offer or contract. Intending purchasers should not rely on them as statements of representation of fact, but must satisfy themselves by inspection or otherwise as to their accuracy. No person in this firm's employment has the authority to make or give any representation or warranty in respect of the property.

